

# Find Your Space.

506 Prudential Road  
Horsham, PA 19044

18,200 sf  
Available for Lease

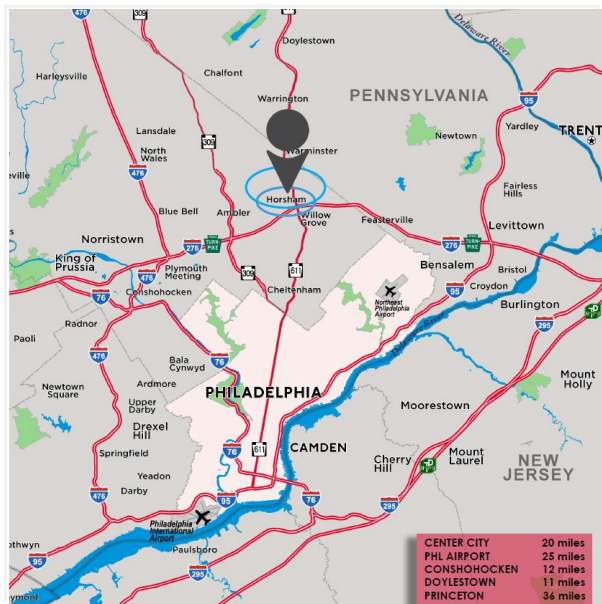

View new floorplan on next page

## Property Highlights



### PARK AMENITIES

Numerous shopping centers, hotels, dining options, banking, retail, daycare and fitness centers under a 2-minute drive. Plus, sports leagues, landlord-coordinated social and networking events.



### TRANSPORTATION

Proximate access to PA Turnpike, Routes 611 and 309, SEPTA Routes 80 & 310 with multiple stops throughout the Pennsylvania Business Campus.



### TAXES

No Business Privilege or Occupational Tax in Horsham Township.



### TECHNOLOGY

Comcast & Verizon available throughout.



### SUSTAINABILITY

Landlord will collaborate with tenant should they desire LEED certification for space improvements.



### WORKSPACE PROPERTY TRUST (WSPT®)

WSPT is a privately held, vertically integrated, full-service commercial real estate company specializing in the ownership, management, leasing, and development of Office, and Industrial / R&D / Flex (IRDF) spaces. Workspace owns and operates approximately 18 million square feet across over 200 properties in sought-after markets, including 13 of the top 20 US metropolitan areas.

Our Space Works.



506 Prudential Road | 18,200 | Horsham, PA

FOR LEASE

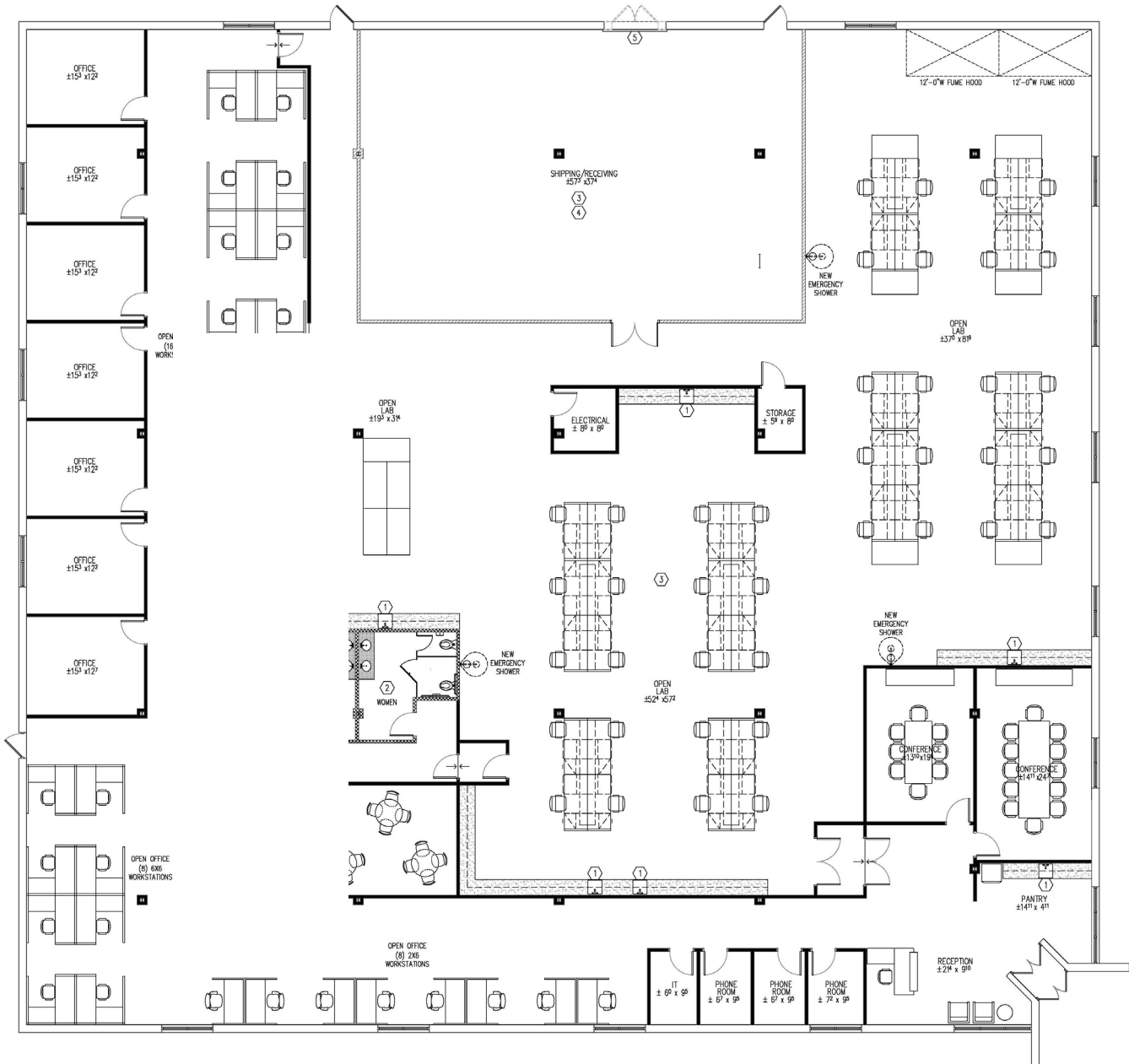

- Ideal layout for lab user
- Ample parking
- Suitable for single tenant occupancy

**LEASING  
INFORMATION**

700 Dresher Road  
Suite 150  
Horsham, PA 19044  
[www.workspaceproperty.com](http://www.workspaceproperty.com)

FOLLOW US ON



@workspacepropertytrust