

Industrial / R&D / Flex (IRDF)

workspace
property trust



Our Space works.

Property Highlights



Availability:
±10,402 SF



Year Built:
2007



Parking:
6/1,000 RSF



Asking Rate:
\$15.95 NNN



Space Condition
2nd Generation



Highlights:

- Available immediately
- Premier business park
- Institutionally owned
- Excellent freeway access
- Close proximity to airport



Workspace Property Trust (WSPT®)

WSPT is a privately held, vertically integrated, full-service commercial real estate company specializing in the ownership, management, leasing, and development of Office, and Industrial / R&D / Flex (IRDF) spaces. Workspace owns and operates approximately 18 million square feet across over 200 properties in sought-after markets, including 13 of the top 20 US metropolitan areas.

Find Your Space.

4750 S 44th Place
Phoenix, AZ

±10,402 SF
Available for lease

Jones Lang LaSalle Americas, Inc.
License #: CO508577000



±10,402 SF

Suite 100

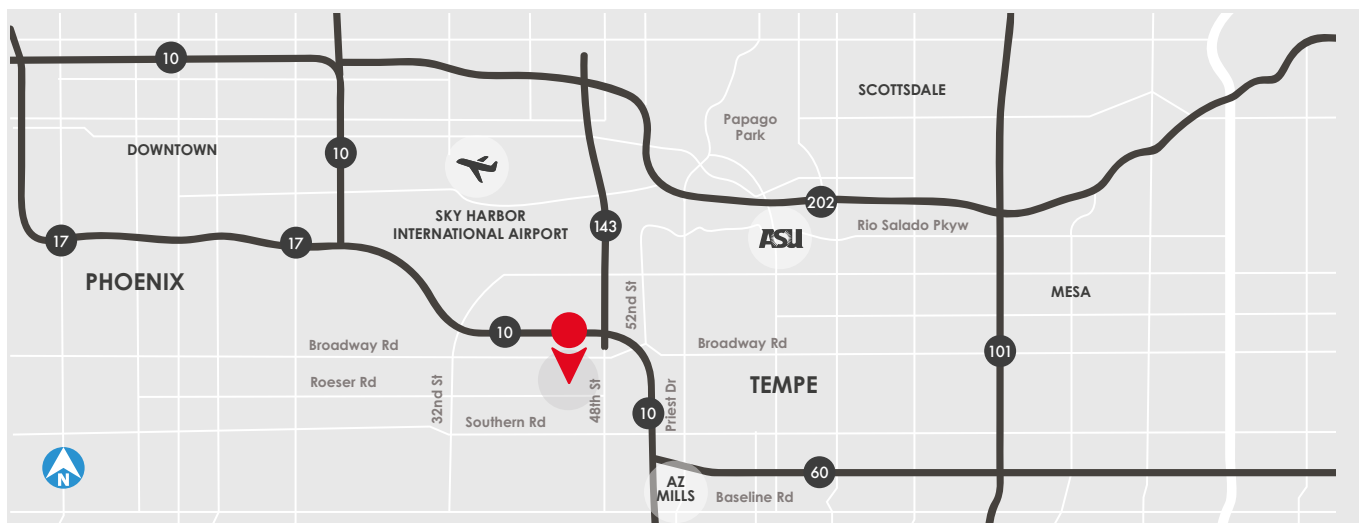
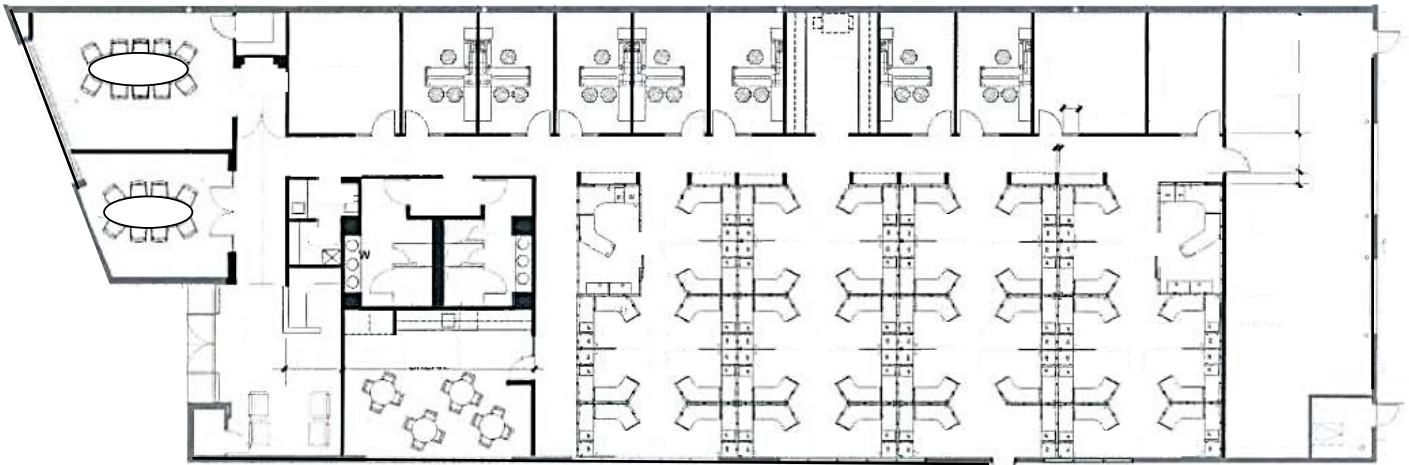

© 2022 Jones Lang LaSalle IP, Inc. All rights reserved. All information contained herein is from sources deemed reliable; however, no representation or warranty is made to the accuracy thereof.

 **Find Your Space.**

Leasing Information

For Flex Inquiries:

Steve Larsen, SIOR, CCIM
602 282 6296
steve.larsen@am.jll.com

For Office/Life Science Inquiries:

Mark Gustin, SIOR, CCIM
602 282 6316
mark.gustin@am.jll.com

Jimmy Cornish
602 282 6363
jimmy.cornish@am.jll.com