



# NORTHGATE

## CORPORATE CENTER

2625 W GRANDVIEW RD | PHOENIX, AZ

±131,850 SF OFFICE  
BUILDING FOR LEASE

**workspace**  
property trust

**CBRE**







PLUG & PLAY



FITNESS CENTER



DINING AREA

# BUILDING FEATURES



±131,850 SF one-floor office building



Divisible to ±40,000 SF



7.4/1000 parking with 974 total spaces including multi-level parking deck: 570 surface (66 covered), 25 surface (Grandview Rd), 379 garage (239 covered)



Fixtures, furniture & equipment available



Finished 12' ceiling height



Cummins 750 kW backup generator



I-17 building signage



Lumen Technologies and Cox Communications services available



Excellent access to I-17, northwest labor markets, amenities, and residential areas



Over 2 million SF of retail within 3 miles (the Shops at Norterra, Happy Valley Town Centre, and Deer Valley Town Center)

# FLOOR PLANS

FULL ±131,850 SF  
BUILDING AVAILABLE

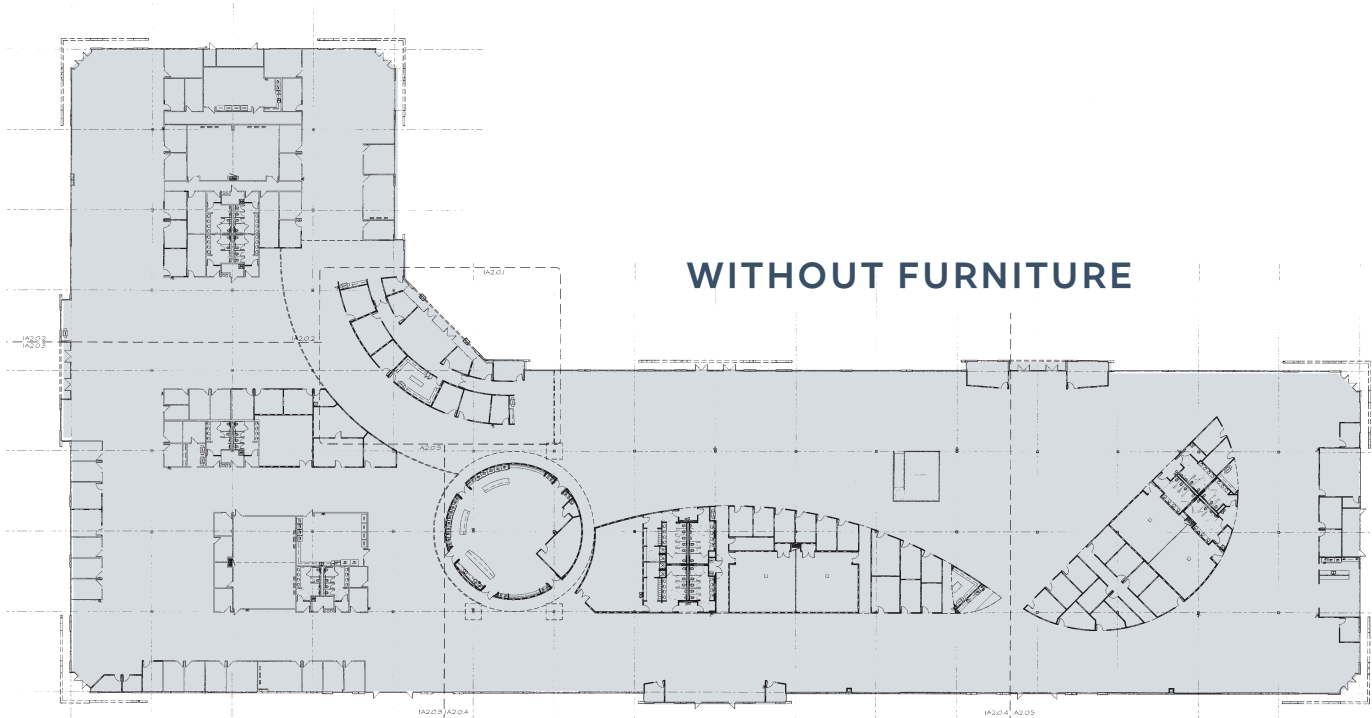
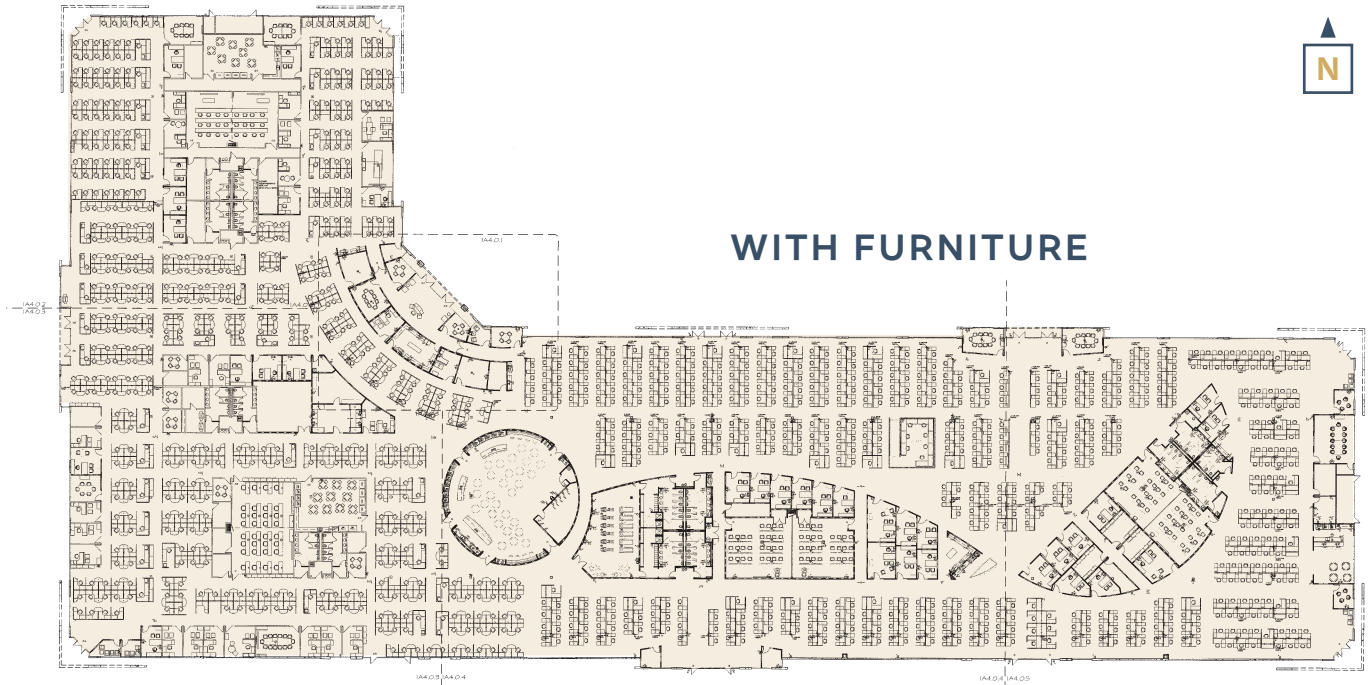





# NORTHGATE

## CORPORATE CENTER

### CONTACTS

**ASHLEY BROOKS, JR.**  
 +1 602 735 1758  
 ashley.brooks@cbre.com

**JAMES BAYLESS**  
 +1 602 735 1794  
 james.bayless@cbre.com



© 2023 CBRE, Inc. All rights reserved. This information has been obtained from sources believed reliable, but has not been verified for accuracy or completeness. You should conduct a careful, independent investigation of the property and verify all information. Any reliance on this information is solely at your own risk. CBRE and the CBRE logo are service marks of CBRE, Inc. All other marks displayed on this document are the property of their respective owners, and the use of such logos does not imply any affiliation with or endorsement of CBRE. Photos herein are the property of their respective owners. Use of these images without the express written consent of the owner is prohibited.