

747 Dresher Road | Suite 100

Horsham, PA 19044

workspace
property trust

17,018 SF Available Now

Office Space



747 Dresher Road I Suite 100

Horsham, Pennsylvania, 19044

PROPERTY HIGHLIGHTS

AMENITIES

Located and highly visible on Welsh Road in the Pennsylvania Business Campus, 747 Dresher Road is a single-story, multi-tenant office building with direct suite access and convenient access to public transportation.

The PBC is surrounded by shopping centers, restaurants, fitness centers, banks, daycare and other amenities

TRANSPORTATION

The Pennsylvania Business Campus is near the Pennsylvania Turnpike, Route 611 and Route 309 providing access to New York, Princeton, Trenton and Philadelphia.

Horsham Township's h.o.p.s shuttle service is also available to tenants, facilitating transportation between the SEPTA Regional Rail, the Horsham Business Center & the PA Lifestyle Campus.

SUSTAINABILITY

Energy Star labeled building. Green initiatives in place by tenants and property management to include janitorial and recycling.

Building Owner: Workspace Property Trust

Total Building Size: 53,200

Ceiling Height: 8'6"



17,018 SF Available Now

Office Space



Open Floor Concept



Conference Room



Ample, Natural Light

17,018 SF Available Now

747 Dresher Road I Suite 100



Spaces for the Way Work Happens Today.

These beautifully designed themes inspire creativity and encourage productivity. Whether you are looking for 1,000 square feet or 100,000 square feet, our in-house design & development team can deliver a turnkey office solution.

Tailored for the Evolution of Office:

- "A La Carte" or "On Demand" Furniture Packages Available
- Plug & Play IT Packages Available



Scan here to learn more about our premium theme selects.

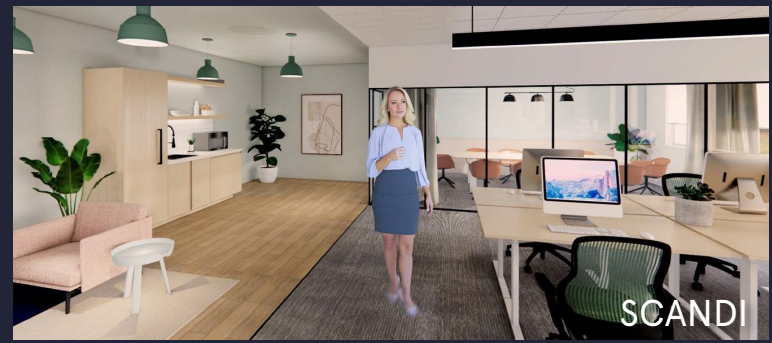

SCANDI



AZURE



TAHOE

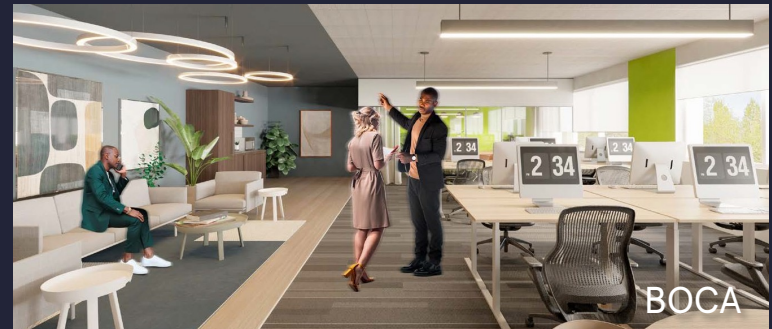

BOCA

*Indicative of the look and feel (not the actual suite)