

110 Gibraltar Road | Suite 223

Horsham, PA 19044

workspace
property trust

2,496 SF New Spec Suite Available for Lease



Rendering

110 Gibraltar Road | Suite 223

Horsham, Pennsylvania, 19044

PROPERTY HIGHLIGHTS

AMENITIES

110 Gibraltar Road is a two-story, multi-tenant office building within the sought-after Pennsylvania Lifestyle Campus featuring new, energy-efficient windows, a modern lobby, and on-site EV charging stations. Tenants enjoy the proximity to countless lifestyle centers, the walkability to restaurants, an on-campus daycare facility, and a seasonal beer garden.

Additionally, tenants have access to the on-campus fitness center complete with showers and changing space, a conference and training facility, outdoor volleyball court, and the 5-mile Horsham Powerline trail with outdoor exercise circuits.

TRANSPORTATION

Commuting to and from the office for employees and visitors across the tri-state area couldn't be easier, as the PA Turnpike, Route 611, and 63 are all within a 5-minute drive from 110 Gibraltar.

Horsham Township's h.o.p.s shuttle service is also available to tenants, facilitating transportation between the SEPTA Regional Rail, the Horsham Business Center & the PA Lifestyle Campus.

Building Owner: Workspace Property Trust

Total Building Size: 59,429

Ceiling Height: 8'4"

2,496 SF Spec Suite Available Now

Office Space



Lounge Seating



Private Conference Room



Locker Access



Open Floor Desk Area



Private Offices

2,496 *SF New Spec Suite Office Available For Lease

**Can accommodate larger requirements*

110 Gibraltar Road | Suite 223

110 Gibraltar Road | Suite 223

Horsham, PA 19044

2,496 SF New Spec Suite Office Available for Lease

Accommodates up to 33 desks
2 Offices
1 Meeting Room
1 Lounge
1 Coffee bar
18 Lockers
Pantry

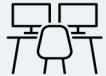

Furnished



IT/AV Packages Available



Expandable

workspace
property trust

Leasing Information

700 Dresher Road, Suite 150
(215) 328-2732
www.workspaceproperty.com

Doug. Himmelreich
Director of Leasing
dhimmelreich@workspaceproperty.com

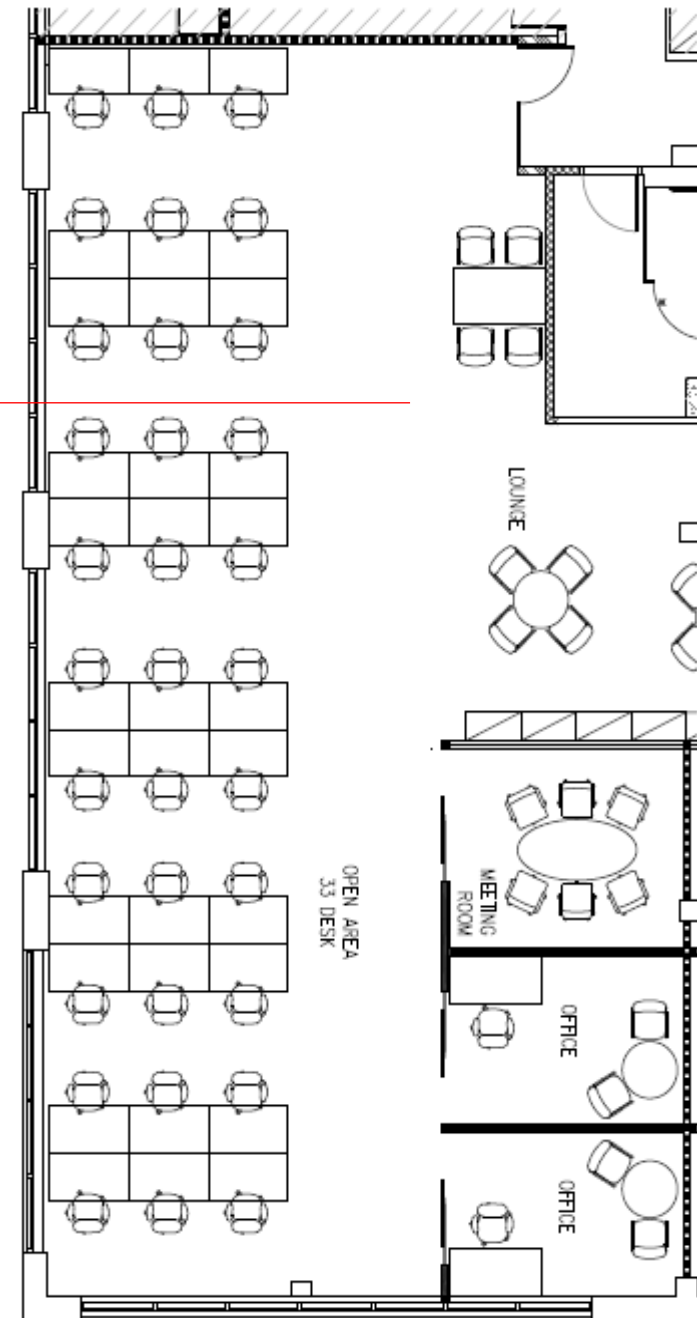



Spaces for the Way Work Happens Today.

These beautifully designed themes inspire creativity and encourage productivity. Whether you are looking for 1,000 square feet or 100,000 square feet, our in-house design & development team can deliver a turnkey office solution.

Tailored for the Evolution of Office:

- “A La Carte” or “On Demand” Furniture Packages Available
- Plug & Play IT Packages Available



Scan here to learn more about our premium theme selects.



SCANDI



AZURE



TAHOE

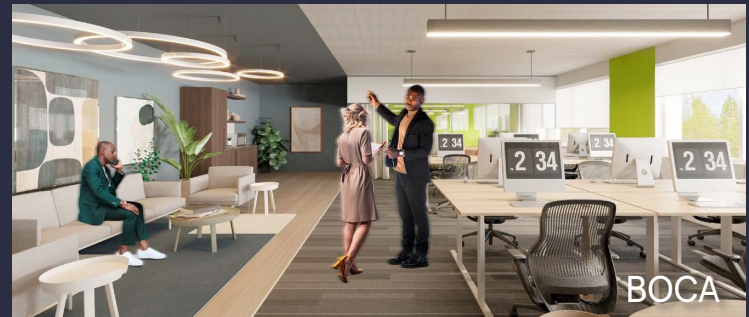

BOCA

*Indicative of the look and feel (not the actual suite)