

# 680 Blair Mill Road | Entire Building

Horsham, Pennsylvania 19044

**workspace**  
property trust

**115,110 SF Available Now**





# 680 Blair Mill Road | Entire Building

Horsham, Pennsylvania, 19044

## PROPERTY HIGHLIGHTS

### AMENITIES

680 Blair Mill Rd has an outdoor patio with umbrella covering, perfect for answering emails outside paired with free guest Wi-Fi. Full on-site fitness center and cafeteria perfect for tenants to enjoy during or after work. Located at the highly visible intersection of Blair Mill and Witmer Roads in the PA Lifestyle Campus and has convenient access to public transportation.

### TRANSPORTATION

Commuting to and from the office for employees and visitors across the tri-state area couldn't be easier, as the PA Turnpike, Route 611, and 63 are all within a 5-minute drive from 110 Gibraltar.

Horsham Township's h.o.p.s shuttle service is also available to tenants, facilitating transportation between the SEPTA Regional Rail, the Horsham Business Center & the PA Lifestyle Campus.

**Building Owner:** Workspace Property Trust

**Total Building Size:** 115,110 Square Feet

**Finished Ceiling Height:** 10"

**115,110 SF Available Now**

Office Space



Outdoor Seating



Lobby Area



# GYM



# CAFETERIA

115,110 SF Available Now

680 Blair Mill Road | Entire Building

Horsham, Pennsylvania, 19044

# 680 Blair Mill Road | 1<sup>st</sup> Floor

Horsham, Pennsylvania 19044

**workspace**  
property trust

## 38,458 SF Available Now

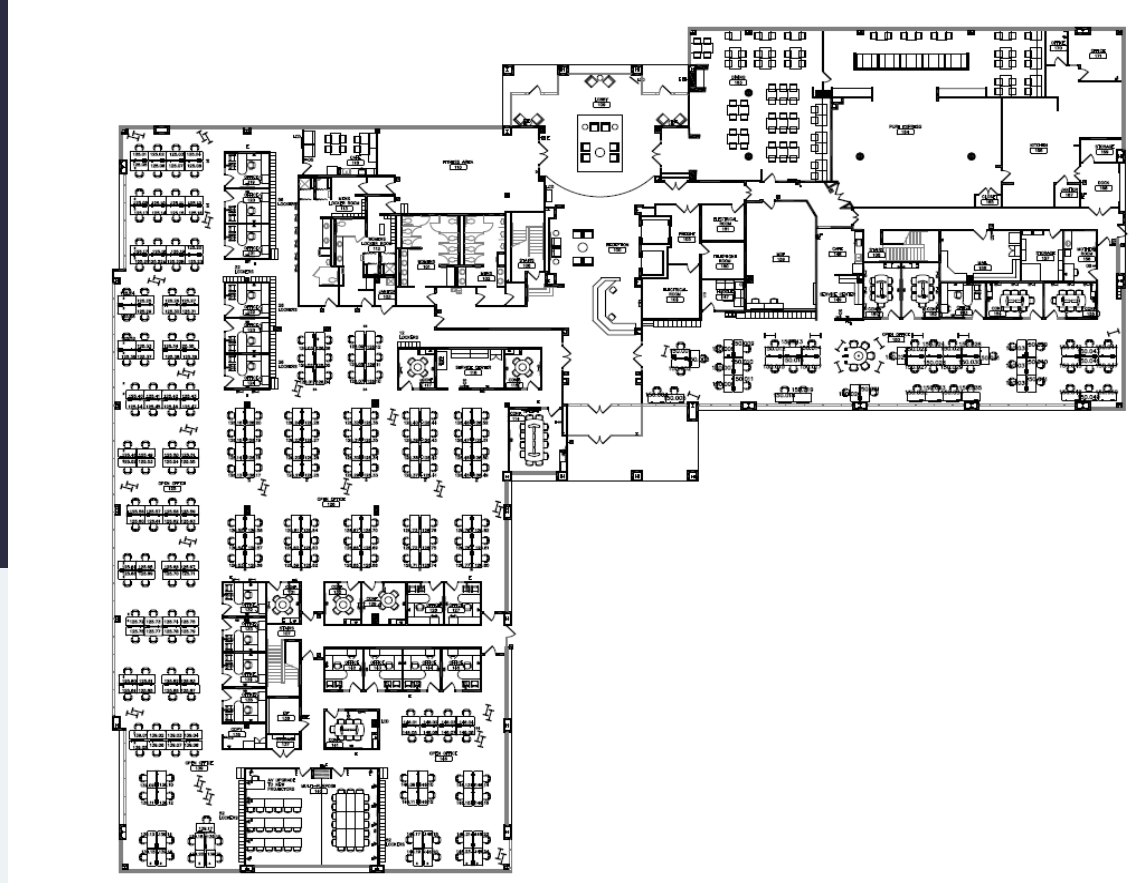

## Leasing Information

700 Dresher Road, Suite 150  
(215) 328-2732  
[www.workspaceproperty.com](http://www.workspaceproperty.com)

Doug, Himmelreich  
*Director of Leasing*  
[dhimmelreich@workspaceproperty.com](mailto:dhimmelreich@workspaceproperty.com)

# 680 Blair Mill Road I 2nd Floor

Horsham, Pennsylvania 19044

**workspace**  
property trust

37,358 SF Available Now

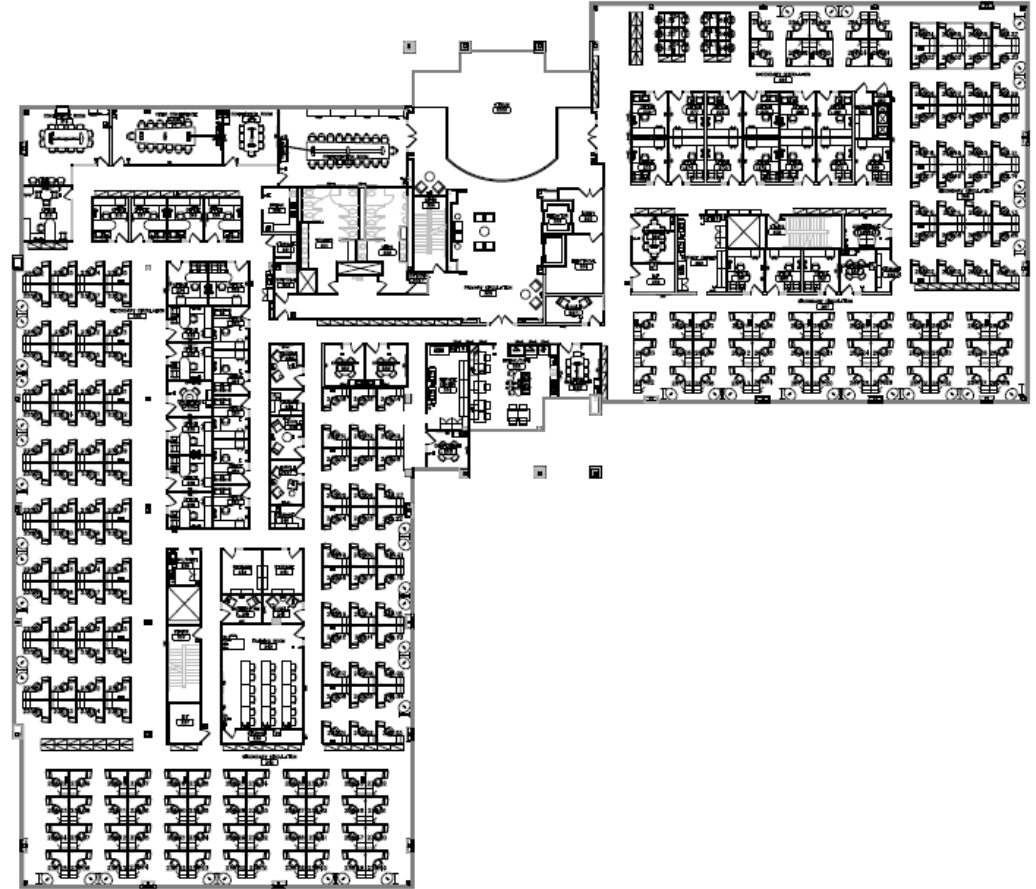

## Leasing Information

700 Dresher Road, Suite 150  
(215) 328-2732  
[www.workspaceproperty.com](http://www.workspaceproperty.com)

Doug, Himmelreich  
Director of Leasing  
[dhimmelreich@workspaceproperty.com](mailto:dhimmelreich@workspaceproperty.com)





# Spaces for the Way Work Happens Today.

These beautifully designed themes inspire creativity and encourage productivity. Whether you are looking for 1,000 square feet or 100,000 square feet, our in-house design & development team can deliver a turnkey office solution.

## Tailored for the Evolution of Office:

- "A La Carte" or "On Demand" Furniture Packages Available
- Plug & Play IT Packages Available



**Scan here** to learn more about our premium theme selects.

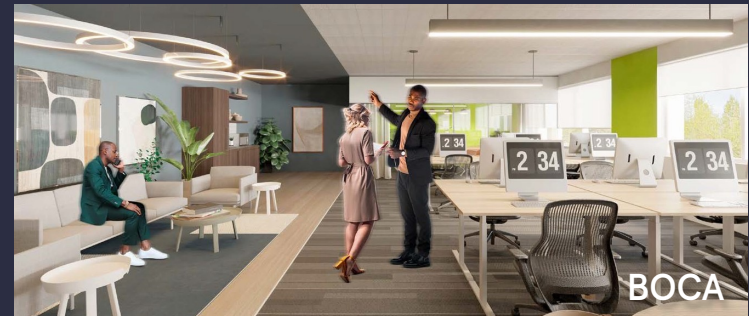

\*Indicative of the look and feel (not the actual suite)