

# 110 Gibraltar Road I Suite 227

Horsham, PA 19044

**workspace**  
property trust

## 1,965 SF New Spec Suite Available 1/1/2026

Office Space



# 110 Gibraltar Road I Suite 227

Horsham, Pennsylvania, 19044

## PROPERTY HIGHLIGHTS

### AMENITIES

110 Gibraltar Road is a two-story, multi-tenant office building within the sought-after Pennsylvania Lifestyle Campus featuring new, energy-efficient windows, a modern lobby, and on-site EV charging stations. Tenants enjoy the proximity to countless lifestyle centers, the walkability to restaurants, an on-campus daycare facility, and a seasonal beer garden.

Additionally, tenants have access to the on-campus fitness center complete with showers and changing space, a conference and training facility, outdoor volleyball court, and the 5-mile Horsham Powerline trail with outdoor exercise circuits.

### TRANSPORTATION

Commuting to and from the office for employees and visitors across the tri-state area couldn't be easier, as the PA Turnpike, Route 611, and 63 are all within a 5-minute drive from 110 Gibraltar.

Horsham Township's h.o.p.s shuttle service is also available to tenants, facilitating transportation between the SEPTA Regional Rail, the Horsham Business Center & the PA Lifestyle Campus.

**Building Owner:** Workspace Property Trust

**Total Building Size:** 59,429

**Ceiling Height:** 8'4"

1,965 SF Spec Suite Available 1/1/2026

Office Space



Lounge Seating



Open Floor Desk Area





Locker Access



Private Spec Suite Office

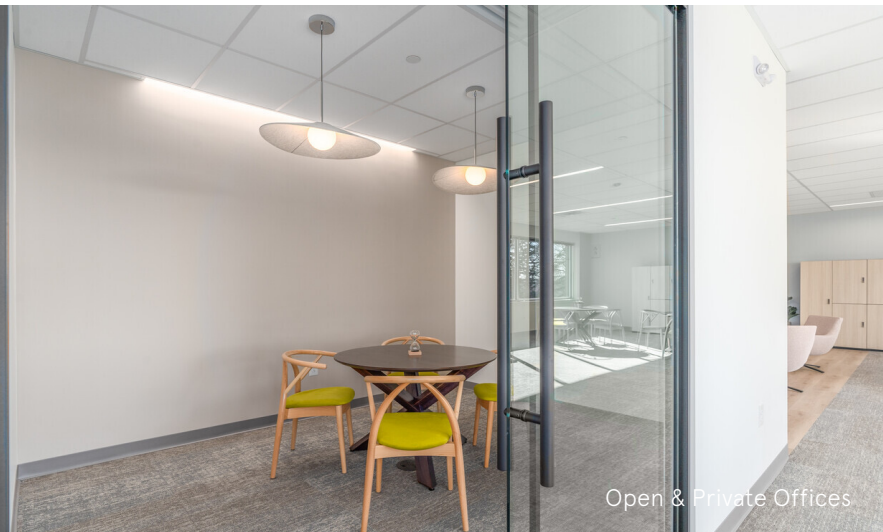

Open & Private Offices



Modern Furnishes

1,965 \*SF New Spec Suite Office Available 1/1/2026

*\*Can accommodate larger requirements*

110 Gibraltar Road | Suite 227

# 110 Gibraltar Road I Suite 227

Horsham, PA 19044

**1,965 SF New Spec Suite Office Available 1/1/2026**

Accommodates up to 18 desks  
2 Offices  
1 Meeting Room  
1 Lounge  
1 Coffee bar  
18 Lockers  
Pantry

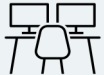

**Furnished**



**IT/AV Packages Available**



**Expandable**

**workspace**  
property trust

## Leasing Information

700 Dresher Road, Suite 150  
(215) 328-2732  
[www.workspaceproperty.com](http://www.workspaceproperty.com)

Doug, Himmelreich  
Director of Leasing  
[dhimmelreich@workspaceproperty.com](mailto:dhimmelreich@workspaceproperty.com)

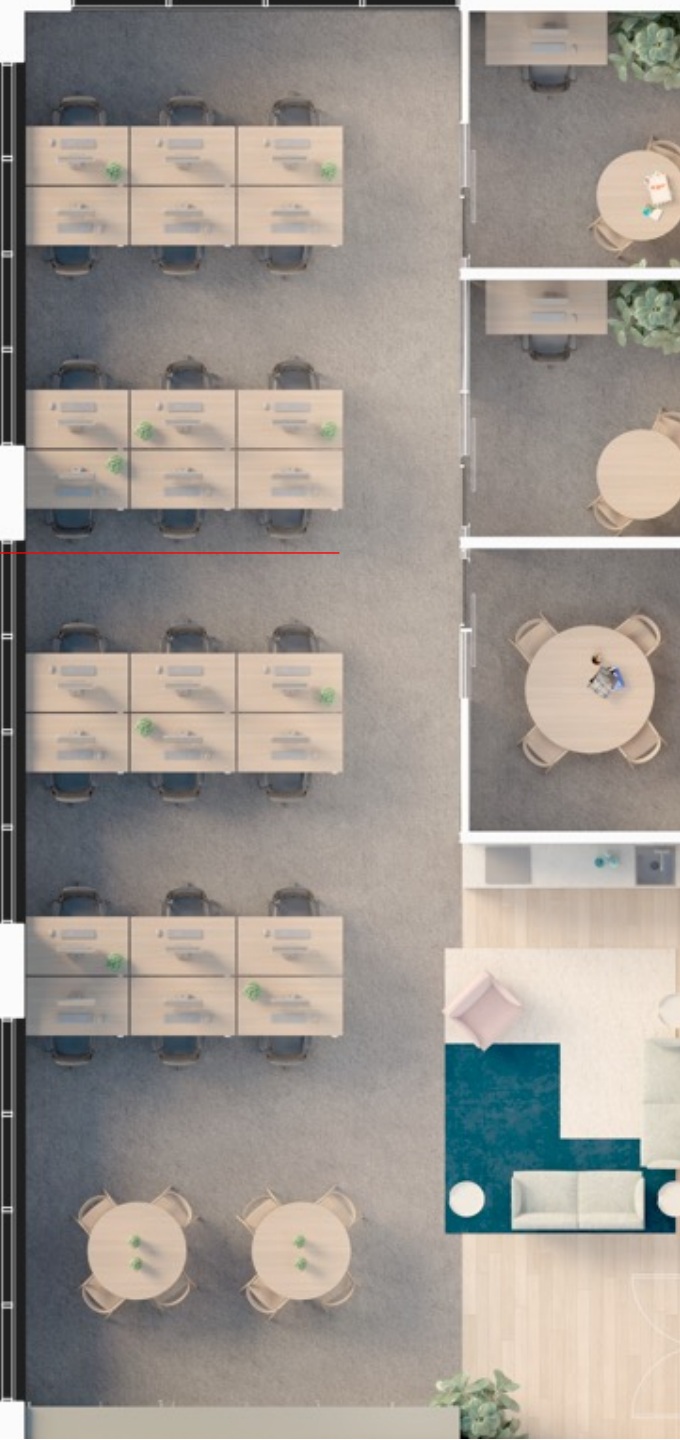





# Spaces for the Way Work Happens Today.

These beautifully designed themes inspire creativity and encourage productivity. Whether you are looking for 1,000 square feet or 100,000 square feet, our in-house design & development team can deliver a turnkey office solution.

## Tailored for the Evolution of Office:

- "A La Carte" or "On Demand" Furniture Packages Available
- Plug & Play IT Packages Available



**Scan here** to learn more about our premium theme selects.

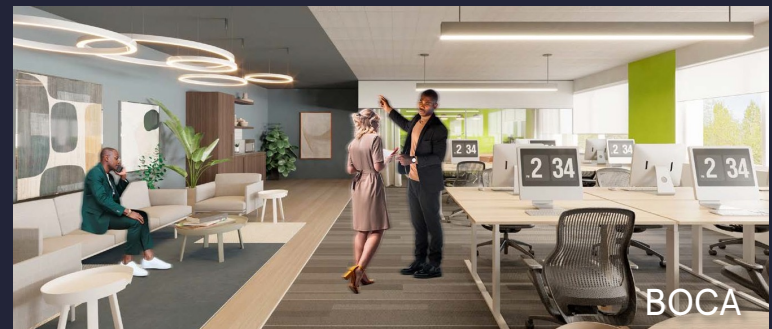
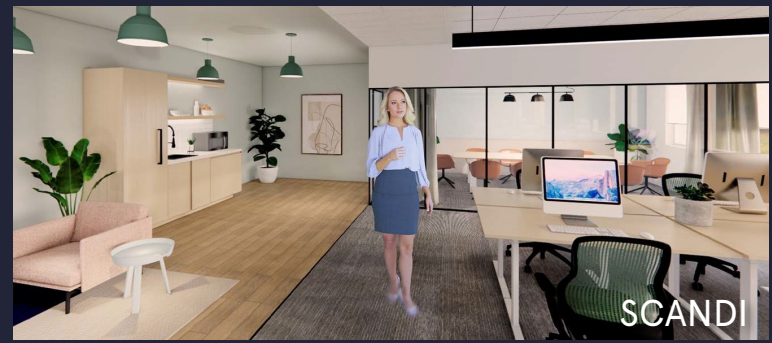

\*Indicative of the look and feel (not the actual suite)