

Boca Colonnade II

750 Park of Commerce Boulevard Suite 200

Boca Raton, FL 33487

8,748 SF Furnished Plug & Play Available Now

workspace  
property trust

Asking Rent: \$32.00/NNN  
2026 OPEX: \$15.36 RSF

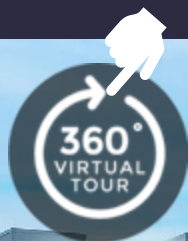



# 750 Park of Commerce Boulevard

Boca Raton, Florida 33487

## PROPERTY HIGHLIGHTS

### AMENITIES

Class "A" office building with an abundant parking ratio of 4.5/1,000 SF. Hurricane impact glass, structured garage parking, newly painted exterior, visitor/guest parking, showers on the ground floor, electric vehicle charging stations, high-quality fiber optic network available throughout the building, on-site security, property management, conference facility and café with views of a nature preserve.

### TRANSPORTATION

Immediate access to Interstate 95. Free shuttle service from Tri-Rail with The Park at Broken Sound Shuttles

### TECHNOLOGY

AT&T, Comcast, Level 3

### SUSTAINABILITY

LEED Gold

**Building Owner:** Workspace Property Trust

**Total Building Size:** 95,331 SF

**8,748 SF Available Now**



Lobby Area



Outdoor Lounge

# 750 Park of Commerce Boulevard Suite 200

Boca Raton, Florida 33487

## 8,748 RSF Furnished Plug & Play Available Now

Elevator Landing

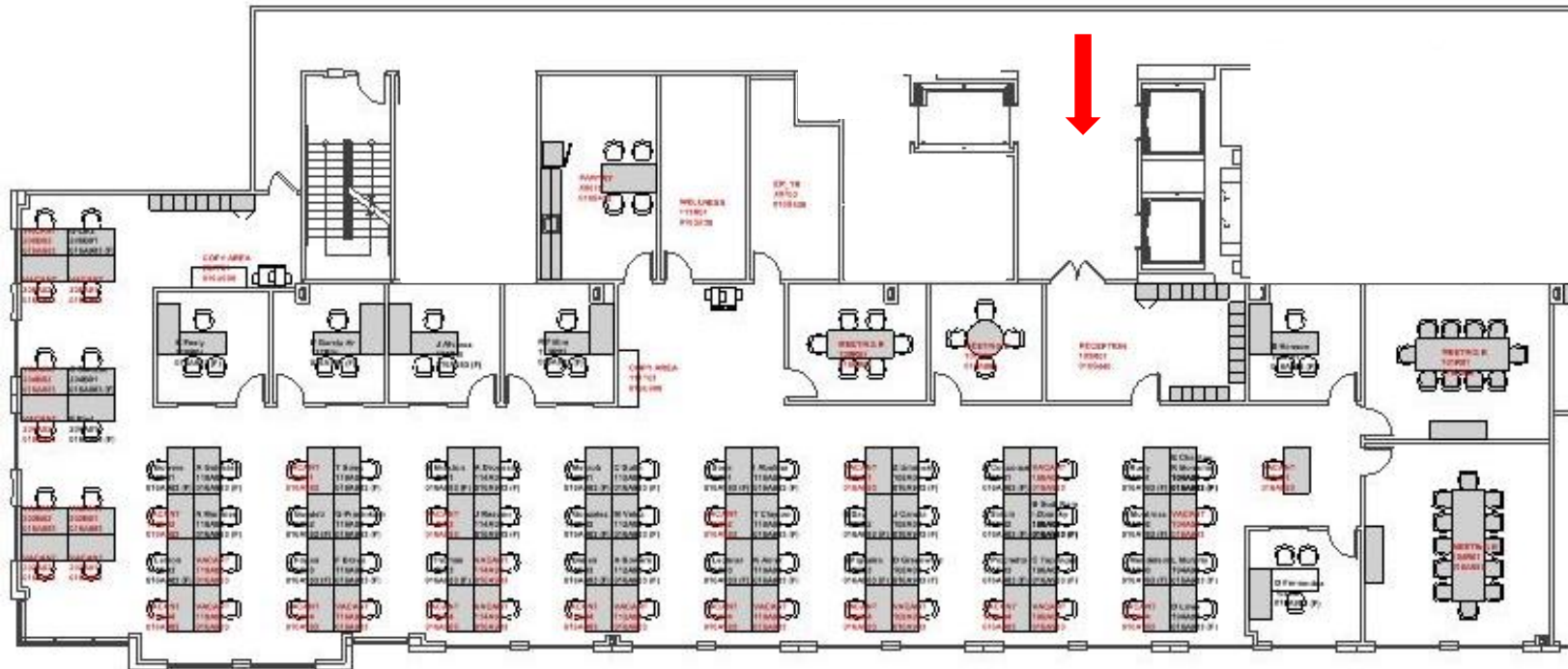

### Leasing Information

777 Yamato Road, Suite 105, Boca Raton, FL, 33431  
(954) 391-5503  
[www.workspaceproperty.com](http://www.workspaceproperty.com)

Mike, Nathanson  
Director of Leasing  
[mnathanson@workspaceproperty.com](mailto:mnathanson@workspaceproperty.com)





# Spaces for the Way Work Happens Today.

These beautifully designed themes inspire creativity and encourage productivity. Whether you are looking for 1,000 square feet or 100,000 square feet, our in-house design & development team can deliver a turnkey office solution.

## Tailored for the Evolution of Office:

- “A La Carte” or “On Demand” Furniture Packages Available
- Plug & Play IT Packages Available



Scan here to learn more about our premium theme selects.

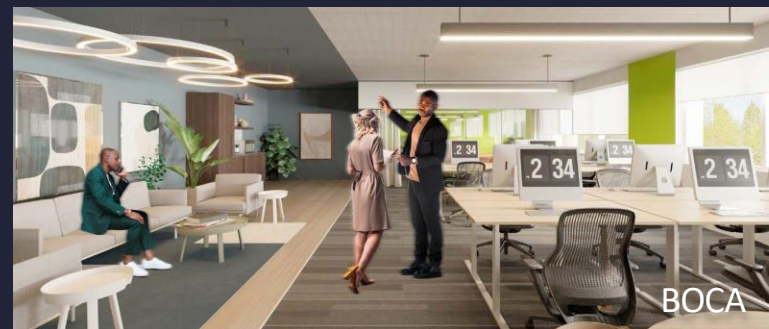

\*Indicative of the look and feel (not the actual suite)